



ATLAS METAL

1135 N.W. 159th DRIVE, MIAMI, FLORIDA 33169

TEL 305.625.2451

TOLL FREE 800.762.7565

FAX 305.623.0475

WWW.ATLASFOODSERV.COM

SALES@ATLASFOODSERV.COM

Project: _____

Item No.: _____

Quantity: _____

MODULAR UNITS BL SERIES



BLC-4-BU SHOWN W/ ACCESSORIES

COLD FOOD UNIT

Ice Cold Pan
Buffet Style

- BLC-2-BU
- BLC-3-BU
- BLC-4-BU
- BLC-5-BU
- BLC-6-BU

SPECIFICATIONS

TOP: Constructed of 16 gauge, type 304 stainless steel, die-formed, welded, ground and polished to a uniform finish. The top includes a rolled front and rear edge.

BODY: Frame construction shall be of hi-tensile aluminum square tubing, 1-1/4", with 3-3/4" extruded, vertical radius corners on front and rear. Frame sections are all welded construction, ground and polished to a uniform finish. Body is complete with front and end panels of .050 aluminum, and an 8-5/8" rear apron of .090 aluminum, all covered with plastic laminate, with stainless steel sliding rear doors covered in plastic laminate. Owner to specify laminate selection. A cam-lock locking system is included with each unit to align and retain cart positioning when two or more units are joined.

ICED COLD PAN: The cart includes an iced cold pan, 4-5/8" deep, built into the top, constructed of 18 gauge, type 304 stainless steel. The pan is fully insulated with high density polystyrene, 1" thick on all sides, 2" thick on the bottom, and enclosed with a 22 gauge galvanized steel outer case. The interior liner is fabricated with 1/4" radius coved corners. A 3/4" dia. drain with strainer, 4" PVC nipple and valve is provided. Separator channels to hold 12" x 20" food pans are included.

CASTERS: N.S.F. approved, 5" diameter, non-marking rubber tired, swivel plate casters with grease fittings. Both casters on the operator's side have toe activated brakes.

Specifications subject to change without notice.

STANDARD FEATURES

- Fully insulated to hold ice longer - can be used for ice display, 12" x 20" pans, or fractional size pans with the use of adapter bars
- Front and End Skirts with recessed casters
- Cam-Lock locking device - keeps tops level and equipment in place
- Fully mobile - each unit is provided with 5" dia. swivel casters, two with brakes
- Available in a wide range of plastic laminate panels, polyurethane enamel & powder coated frames and panels to blend with any decor
- Total versatility - available in a variety of lengths
- Rear Sliding Doors, S/S, removable, w/ laminate
- 1-Year Parts & Labor Warranty
- UL Listed

ACCESSORIES

- **TS** - Tray Slide, 12" wide, S/S, solid, ribbed, fold-down
- **SL** - Tray Slide, 11-1/4" wide, S/S, 2-rail, fold-down
- **SLT** - Tray Slide, 11-1/4" wide, S/S, 3-rail, fold-down
- **SLF** - Tray Slide, 11-1/4" wide, plastic laminate w/ S/S runners, fold-down
- **SH** - Work Shelf, 8" wide, S/S, flat, fold-down
- **CB** - Work Shelf, 8" wide, hardwood maple, fold-down
- **CR** - Work Shelf, 8" wide, Richlite, fold-down
- **ES** - End Shelf, 18" wide, S/S, fold-down
- **CBE** - End Shelf, 16" wide, hardwood maple, fold-down
- **REVERSA PANEL** - Front
- **REVERSA PANEL** - Ends (set)
- **BLSF** - S/S Front Panel
- **BLSE** - S/S End Panel (each)
- **PP** - Painted Panels, polyurethane enamel, in lieu of laminate
- **USB** - Bottom Shelf, S/S, removable
- **USMB** - Undershelves, S/S, middle & bottom
- **HD** - Hinged Doors, S/S, w/ plastic laminate
- **DL** - Door Locks (set)
- **Sneeze Guards** - various styles available (see sneeze guard section of catalog)
- **CO** - Convenience Outlet (specify base or apron mount)
- **CO-DUP** - Convenience Outlet, Duplex receptacle
- **JBC** - Outlet Box in base, 4x4 (120V) with cord
- **ERS** - Electrical Raceway System
- **PCS** - 7 to 10 ft. Power Cord
- **CW** - Cord Wrap
- **P-CAST** - Polyurethane Casters, 2-W/Brakes
- **SL-BL** - Legs with adjustable feet, in lieu of casters
- **WFB** - Perforated false bottom
- Adapter Plates & Adapter Bars (pgs. DI-51 - DI-52)
- **CP** - Cover Plate with handles, S/S
- **RDVE** - Rear Drain Valve Extension
- **DPI** - Full Depth Ice Pan, 9-3/4" deep

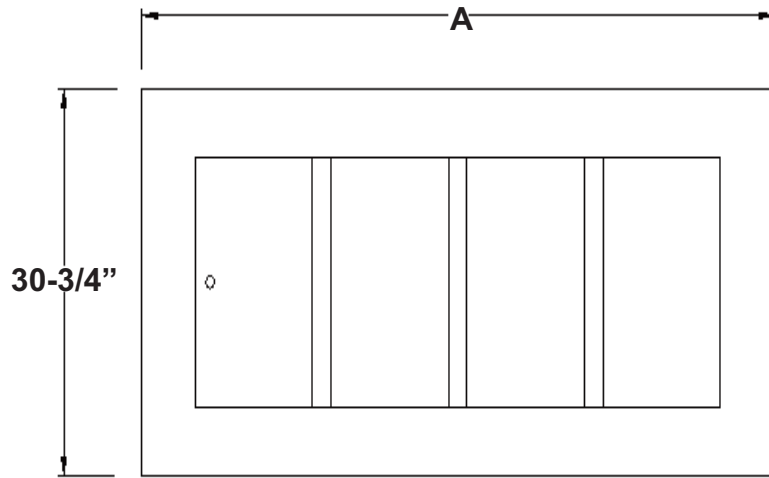

PLAN VIEW

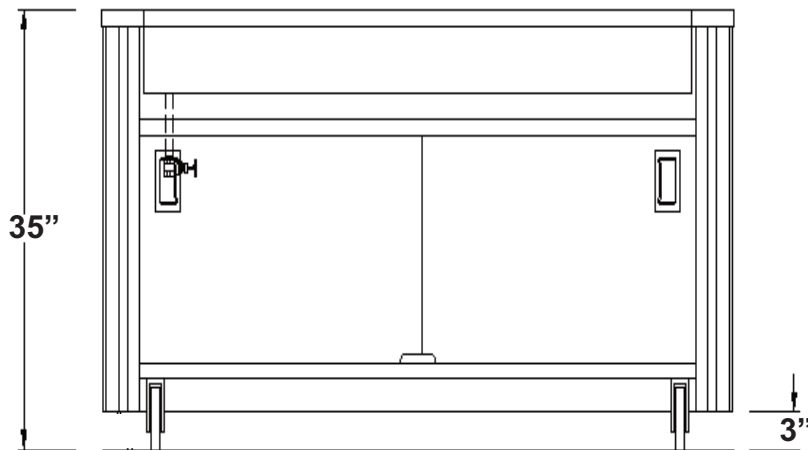

REAR ELEVATION

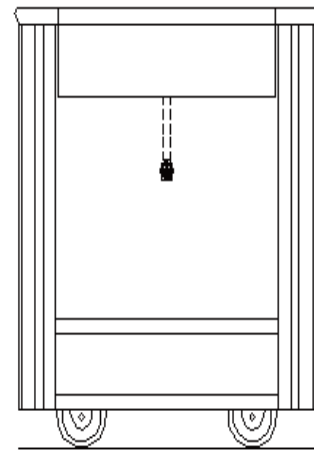

END VIEW

MODEL	"A"	COLD PAN DIMENSIONS	SHIP WT. (lbs.)
BLC-2-BU	36-1/4" (92cm)	25-1/2" X 19-7/8" X 4-5/8" (64.7 X 50.4 X 11.7cm)	175 (79.3kg)
BLC-3-BU	50" (127cm)	39-1/4" X 19-7/8" X 4-5/8" (100.3 X 50.4 X 11.7cm)	220 (99.7kg)
BLC-4-BU	63-3/4" (161.9cm)	53" X 19-7/8" X 4-5/8" (134.6 X 50.4 X 11.7cm)	285 (129.2kg)
BLC-5-BU	77-1/2" (196.8cm)	66-3/4" X 19-7/8" X 4-5/8" (169.5 X 50.4 X 11.7cm)	340 (154.2kg)
BLC-6-BU	91-1/4" (231.7cm)	80-1/2" X 19-7/8" X 4-5/8" (204.4 X 50.4 X 11.7cm)	385 (174.6kg)